

TE 024
Redondo Estriado 32

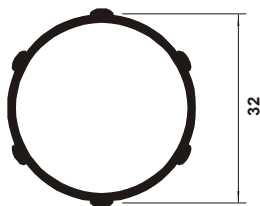

TE 025
Redondo Estriado 22

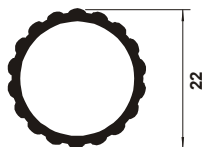

TE 028
Redondo Estriado 19



TE 031
Redondo Estriado 11

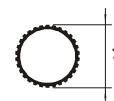

TO 002
Redondo Liso 40

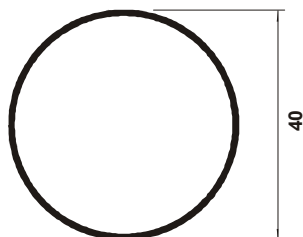

TO 005
Redondo Liso 32 PC

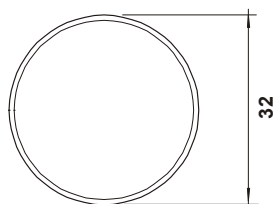

TO 006
Redondo Liso 25

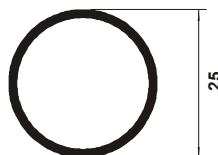

TO 010
Redondo Liso 19



TO 011
Redondo Liso 21 com Base



TO 018
Redondo Liso 8,5 Aberto



TO 024
Redondo Liso 11



TO 027
Redondo Facetado 18,5

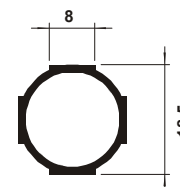

TO 029
Redondo Liso 32

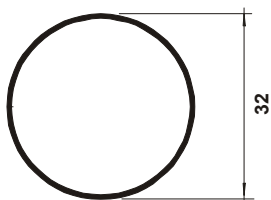

TO 031
Redondo Liso 24,2



TO 032
Redondo Liso 19 PE



TO 033
Redondo Liso 16 PE





Tubos Redondos 2

Vigência

Agosto 2004

TO 034

Redondo Liso 19 ABS



TO 036

Redondo Liso 19

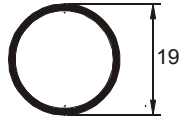

TO 037

Redondo Liso 10



ISO 9001 - Gestão de Qualidade



Certificação N° BR028-110987-3

ⓘ Importante

Todas as medidas estão expressadas em milímetros (mm) e são somente ilustrativas, podendo ser modificadas sem prévio aviso.